

Male Catheter Model Type I LM-029

Instructions for use

Thank you for purchasing our Male Catheter Model Type I.

Please read the instructions for use carefully for a proper use and keep this instructions at hand.

Contents

1. Name of each part
2. Cautions for use
3. Proper method of use
4. Caring and storage after use
5. Composition and specifications



C-1-913-1-01-01

1 Name of each part

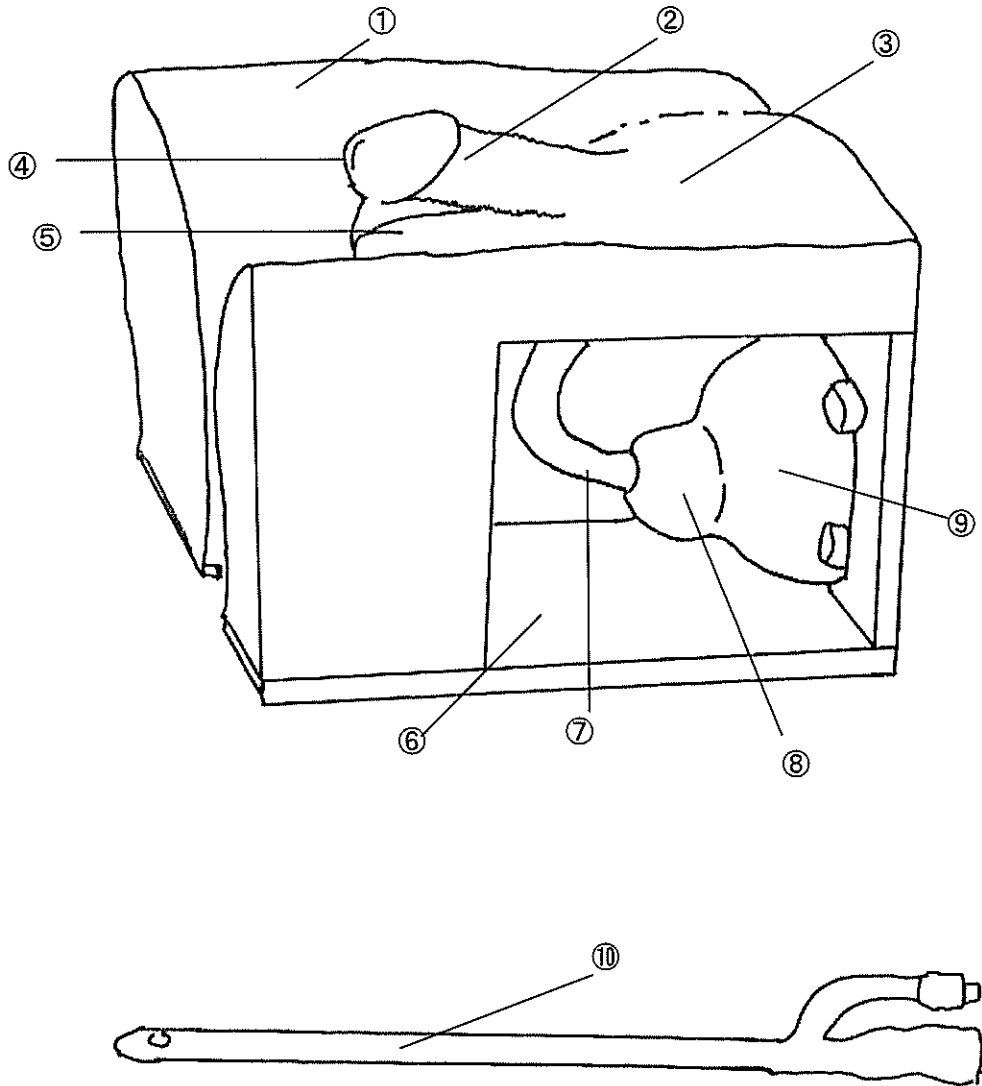

- ① Leg, ② Penis, ③ Abdomen, ④ Urethral exit, ⑤ Scrotum,
⑥ Acrylic stand, ⑦ Urethral tube, ⑧ Prostate, ⑨ Bladder, ⑩ Balloon catheter

2. Cautions for use

1. This model is made of special silicone rubber so as to resemble closely as living form, and it must be handled gently as with a real body.
2. Always apply lubricating oil to the catheter for smooth insertion. If resistance is felt, inject the oil directly into the urethra.
Never insert the catheter by force.
3. The acrylic stand will break if the model is dropped or hit.
4. The inside of the epidermis is sponge. Take care not to soak it.
5. Do not expose the main body of the model directly to the sunlight for a protracted period.

3. Proper method of use

1. If tape is to be used for anchoring the catheter, remove oil and dirt at the surrounding area with detergent or alcohol. Oil and dirt will weaken the adhesive strength of the tape.
2. Apply lubricating oil before starting the urinary catheterization practice.
3. Use a catheter of size No. 16FR or smaller.

4. Caring after use

1. Method of washing off the lubricant

- a. Insert water by directly applying the urethral exit to the tap.
- b. Wash with the water from a polyethylene tank.

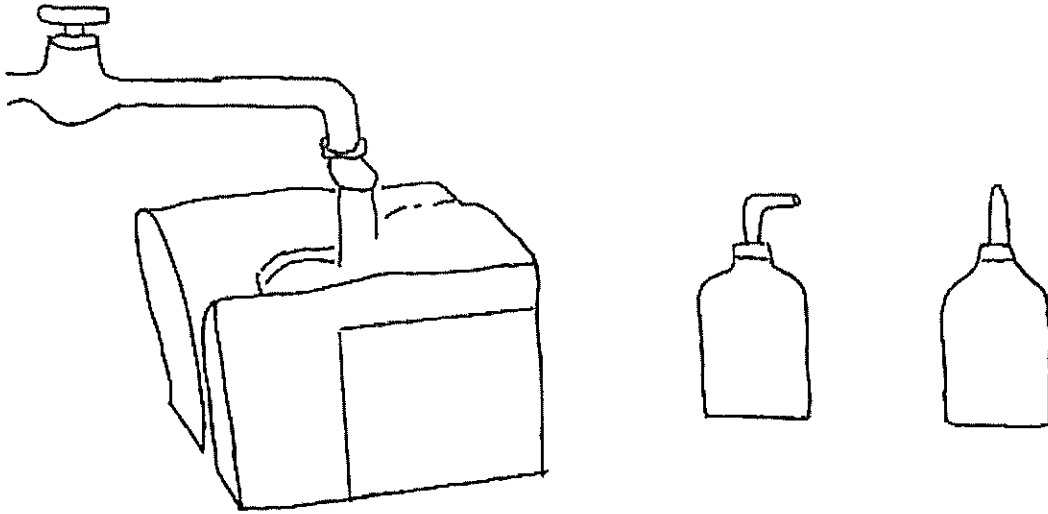

※ It is possible to wash the urethral tube and the bladder separately. Also, the bladder can be washed by removing from the acrylic stand.

2. Washing the epidermis and acrylic stand

If dirt is not removed by cold water or hot water, use a neutral detergent.

3. Store only after drying thoroughly. Never put objects on top of the model or place it upside-down during storage, as this may result in deformation.

5. Composition and specifications

1. Composition

Product name	Quantity
Main body	1
Catheter	1
Storage case	1

2. Specification

Product name	Length (cm)	Width (cm)	Height (cm)	Weight (kg)
Main body	19	22.5	17	1.15
Storage case	26	25	24.5	1.44

KOKEN CO.,LTD <http://www.kokenmpc.co.jp>

1-4-14 Koraku, Bunkyo-ku, Tokyo 112-0004 JAPAN

Email: customer@kokenmpc.co.jp

